



- Multi-function display for incremental encoders
- Position display, tachometer, start/stop speed display, event counter
- Digital or analogue outputs
- Multivoltage supply 24Vdc, 24/42Vac, 115/230Vac
- LD300 display
  - LD301 display with analogue output
  - LD302 preset display with digital outputs
  - LD303 display with serial interface



LD30x

## FUNCTIONS

Counter/Position, Tachometer, Time display, Stop watch, Transition speed, Linearization of analogue output, scaling factor

## ENVIRONMENTAL SPECIFICATIONS

Operating temperature range:	0°C +45°C (+32°F, +113°F)
Storage temperature range:	-20°C +80°C (-4°F, +176°F)
Protection:	IP65 front, IP20 back

## MECHANICAL SPECIFICATIONS

Dimensions:	96 x 48 x 141 mm <sup>3</sup>
Cut out:	91 x 44 mm <sup>2</sup>
Display:	LED, 6 digits x 15 mm (-199999 ÷ 999999)

## ELECTRICAL SPECIFICATIONS

Power supply:	24Vdc ± 20%, 115/230 Vac 24Vdc ± 20%, 24/42 Vac
Consumption:	3,6 W max or 7,5 VA (without sensor)
Counting frequency:	100 kHz max. (counter mode) 25 kHz max. (other operating modes)
Sensor input:	PNP or NPN (HTL) TTL
Interface:	RS232/RS485 (LD303)
Outputs:	LD301: analogue 0/4-20 mA, 0 ±10V LD302: digital PNP 2 x 30V - 150 mA

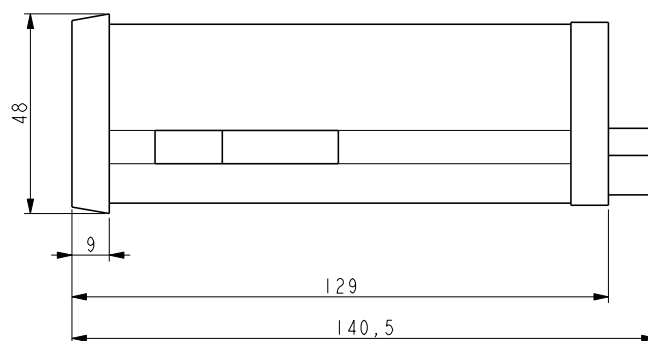
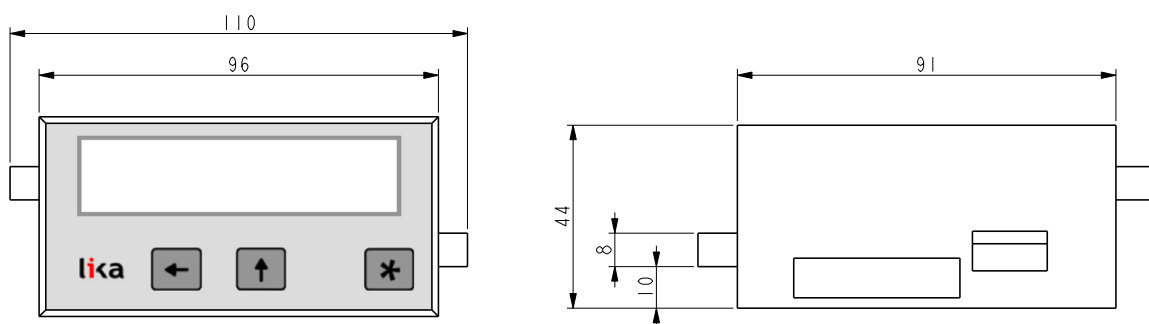

LD300

Order code

LD300	-	XX	-	XX
LD301		Ⓐ		Ⓑ
LD302				
LD303				

Ⓐ POWER SUPPLY	Ⓑ SENSOR INPUT
PM = 24Vdc ±20%, 115/230 Vac	M1 = PNP, NPN (HTL)
P4 = 24Vdc ±20%, 24/42 Vac	M8 = TTL